

TOP MOUNTED
ON CONCRETE
OR WOOD

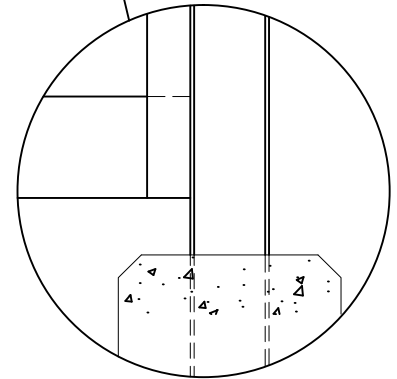

EMBEDED
IN CONCRETE

SPECIFICATIONS:

- POSTS, RAILS:
& PICKETS EXTRUDED MARINE 6063-T5
PRIME ALUMINUM, CANADIAN PRODUCED
- FINISH: SEVEN STAGE ARCHITECTURALLY
CERTIFIED PRETREATMENT AS
PER AAMA 2604
- POSTS: 76mm x 76mm(3"x 3") x 1.65mm WALL OR
51mm x 51mm(2"x 2") x 1.65mm WALL
- POST CAPS: PYRAMID OR BALL
- FENCE BOARD: ALUM. (USED VERTICAL OR HORIZONTAL)
- SIZES: 25mm x 25mm(1"x 1")
25mm x 51mm(1"x 2")
25mm x 76mm(1"x 3")
25mm x 150mm(1"x 5")

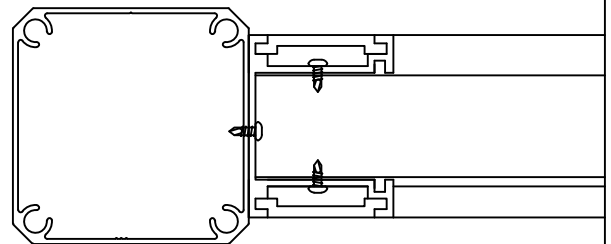

SECTION A-A

*NOTE: FOR CLEAN AND SEAMLESS FINISH, NO FASTENERS ARE EXPOSED.

COMMENTS:

	<p>TITLE: ALUMINUM FENCE PANEL STYLE AF-AP1</p>	<p>DRAWING No. AF-AP1</p>
<p>CHK'D:</p>		<p>DATE: MAR. 29/2020</p>